

Sento faro flat »cc« datasheet

LED ceiling mounted luminaire with a flat base for mounting on cavity box. Connected to a remote constant current source (driver). Modular LED head-body-system allows free combination of different surfaces of head, body and base. Head removable for configuration and maintenance purposes, LED changeable. Heads available with one sided or double sided light output, power of light source 26 W.

Lighting effect changeable by using optional inserts, dichroic color filters can be added. Adjustment via heat-decoupled carbon pin (fixation of head against rotation optional). Controllable via external dimmer (depending on the power supply unit).

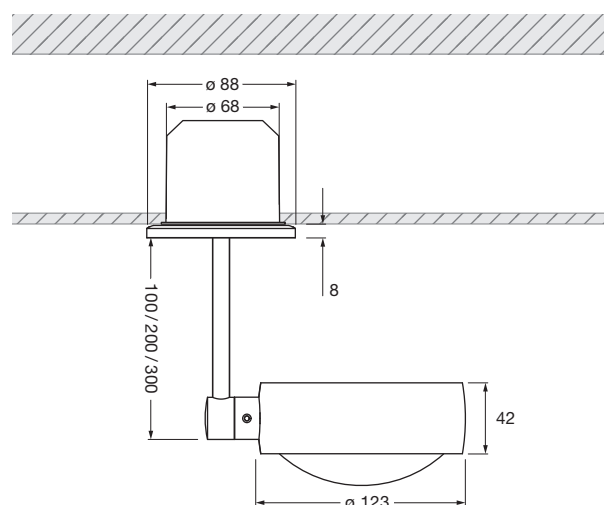

dimensions in mm

technical data Sento faro flat »cc«

properties	material	aluminium, steel chrome-plated, painted or anodised, plastic, glass, optical plastic	
	length	100/200/300 mm	
	rotation head	360°	
	movability body	360° (with stop)	
	weight	1.3 kg	
surface	head	matt gold, rose gold, bronze, chrome, matt chrome, glossy white, matt white, glossy black, matt black	
	body	matt white, matt black, chrome, matt chrome	
	base	chrome, glossy white, matt chrome, matt white, glossy black, matt black	
Occhio LED	average life time	> 50.000 hrs	
	energy efficiency class	A+ / A	
	power single sided / double sided	26 W max. 700 mA (> 36 DC) / max. 2 x 350 mA (> 36 DC)	
	color rendering index	perfect color; CRI Ra 97	high flux; CRI Ra 85
	color temperature	2700, 3000 K	3000, 3500, 4000 K
	recommended use	residential and public	public
electricity	dimming	with trailing edge phase-cut dimmer, push button, DALI or 1-10V (depends on driver)	
	power supply unit	remote, driven by constant current source max. 700 mA / > 36 V DC	
	permitted operating conditions	max. 30°C for indoor use only	

Sento faro flat »cc« lighting effects

 head single sided

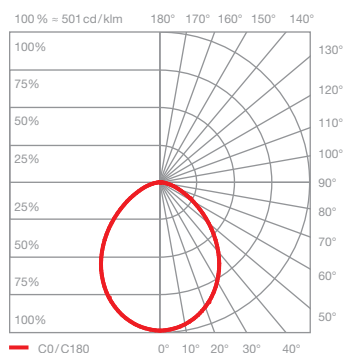
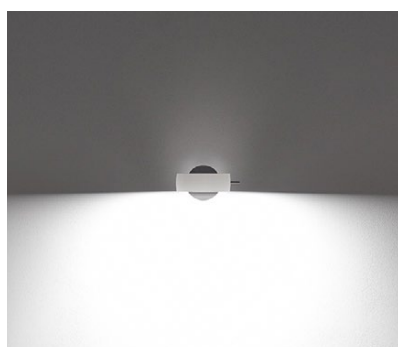

Sento B

diffuse light

insert: diffusor glass

luminous flux: perfect color 26 W 1370 lm
high flux 26 W 1870 lm

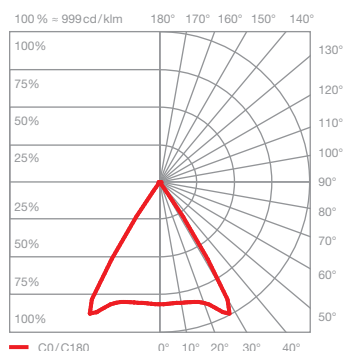

Sento C

directed light
beam angle approx. 80°

insert: lens

luminous flux: perfect color 26 W 1570 lm
high flux 26 W 2150 lm

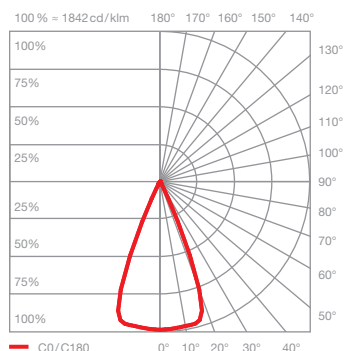
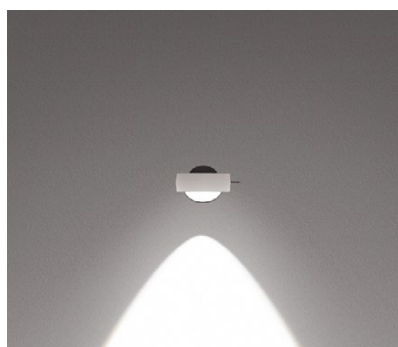

Sento S40

directed light
beam angle approx. 40°

insert: spot lens, lens
soft edge glass

luminous flux: perfect color 26 W 1560 lm
high flux 26 W 2130 lm

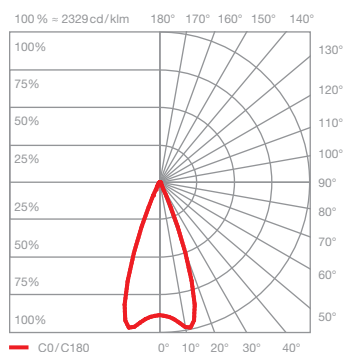
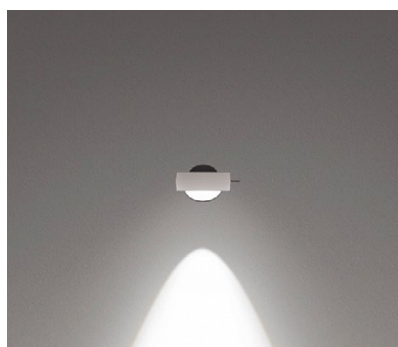

Sento S30

directed light
beam angle approx. 30°

insert: spot lens, lens
fresnel lens

luminous flux: perfect color 26 W 1530 lm
high flux 26 W 2080 lm

Sento faro flat »cc« lighting effects

 head double sided



Sento A

diffuse light in both directions

insert: diffusor glass
diffusor glass

luminous flux:	perfect color	26 W	1500 lm
	high flux	26 W	2040 lm



Sento D

directed light in both directions
beam angle approx. 80°

insert: lens
lens

luminous flux:	perfect color	26 W	1750 lm
	high flux	26 W	2390 lm



Sento E

diffuse up light
directed down light
beam angle approx. 80°

insert: diffusor glass
lens

luminous flux:	perfect color	26 W	1620 lm
	high flux	26 W	2200 lm